



Make the best encoder in China



Accurate feedback, excellent performance



SERVO MOTOR ENCODER



**IDENCODER ENCODER** *MADE IN CHINA*

*Make the best encoder in China*

## SERVO MOTOR ENCODER

- Supports various leaf spring installation structures
- Support multiple communication protocols (BISS-C/SSI)
- Strong reliability, reverse polarity protection, overcurrent protection
- The speed can reach 5MHz

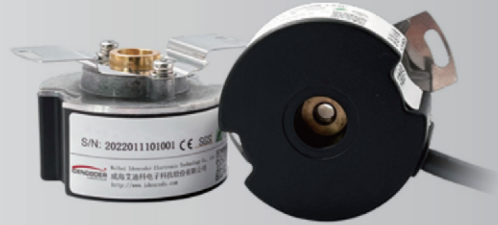

## Machine parameters

### Optional parameters

Main size	Φ35mm □ / Φ44mm □ / Φ48mm □ / other
Shaft size	Taper hole Φ9mm □ / blind hole Φ8mm □ / Straight hole Φ6mm □ / other
Leaf spring installation indexing circle dimensions	Φ40mm □ / Φ55mm □ / Φ67mm □ / other

### Machine size

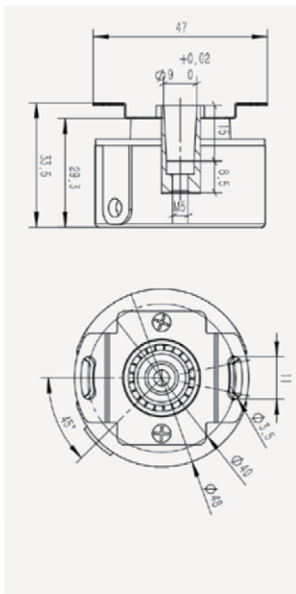

□ 4809-40 leaf spring

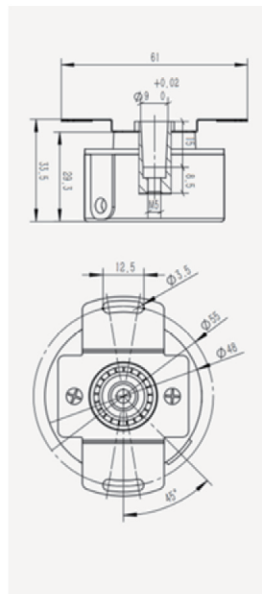

□ 4809-55 leaf spring

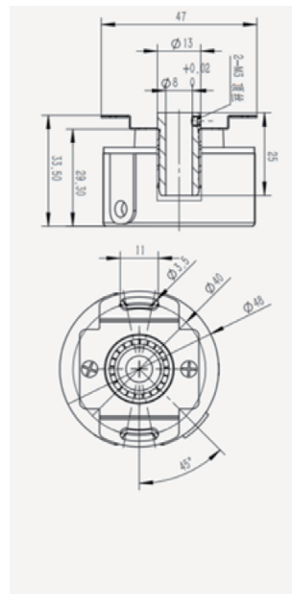

□ 4808-40 leaf spring

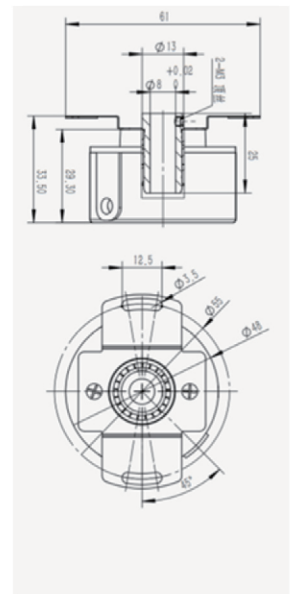

□ 4808-55 leaf spring

## General parameters

Flange form	Leaf spring+shaft hole
Flange material	cast aluminium
Output cable	Cable side output
Shaft material	Brass
Housing material	Plastic
Start torque	$9.8 \times 10^{-3}$ (N · M)
Axis load	$\leq 10$ N
Radial load	$\leq 20$ N
Machine rotary	$\leq 5000$ rpm
Anti-vibration	10g,10 ~ 2KHz
Impact resistance	100g,3ms
Weight	200g

## Electrical parameters

### Optional parameters

Quantity of pole pair	4□ / 5□ / other
Resolution	2500□ / 5000□ / other
Cable length	0.17m□ / 0.65m□ / other

## General parameters

Output form	Differential output
Voltage	5VDC $\pm$ 5%
Single load current	$\leq 20$ mA
Electrostatic discharge	Electromagnetic compatibility, compliant with IEC61800-3 standards
Power reverse connection protection	Yes
Overcurrent protection	Yes

Wiring definition	Standard type															
	Signal	DC5V	GND(0V)	A	A-	B	B-	Z	Z-	U	U-	V	V-	W	W-	Shield
	Color	Red	Black	Blue	Blue/black	Green	Green/black	Yellow	Yellow/black	Brown	Brown/black	Gray	Gray/black	White	White/black	Thick black
Wiring definition	Save cable type															
	Signal	DC5V	GND(0V)	A	A-	B	B-	Z	Z-	Shield						
	Color	Red	Black	Blue	Blue/black	Green	Green/black	Yellow	Yellow/black	Thick black						

# SERVO ENCODER—ABSOLUTE

## SERVO MOTOR ENCODER

- Supports various leaf spring installation structures
- Support multiple communication protocols (BISS-C/SSI)
- Strong reliability, reverse polarity protection, overcurrent protection
- The speed can reach 5MHz

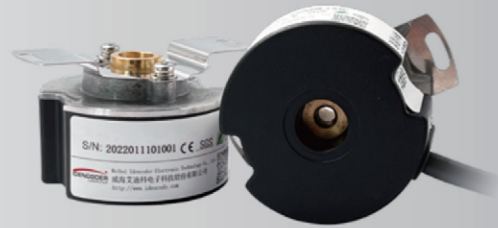

## Machine parameters

### Optional parameters

Main size	Φ35mm □ / Φ44mm □ / other
Shaft size	Taper hole Φ9mm □ / blind hole Φ8mm □ / Straight hole Φ6mm □ / other
Leaf spring installation indexing circle dimensions	Φ40mm □ / Φ55mm □ / other

### Machine size

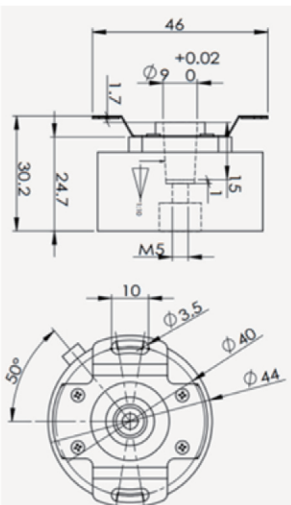

□ 4409-40 leaf spring

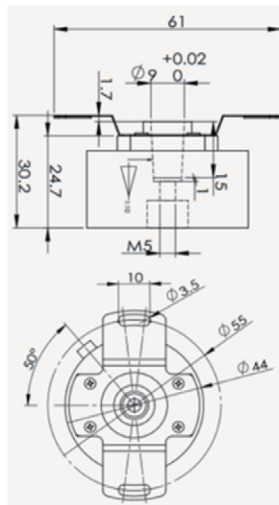

□ 4409-55 leaf spring

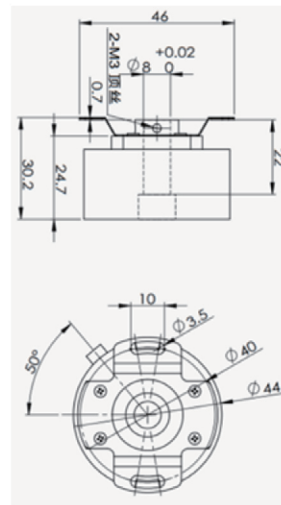

□ 4408-40 leaf spring

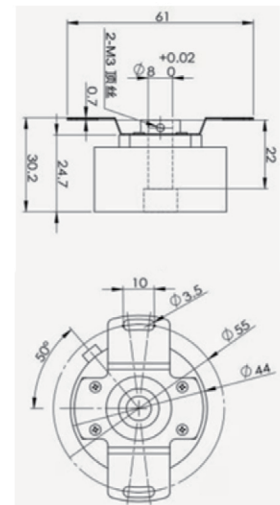

□ 4408-55 leaf spring

### Environment parameters

Work temperature	-20°C~ +85°C
Stock temperature	-20°C~ +90°C
Protection level	IP40
Max humidity	85% No condensation

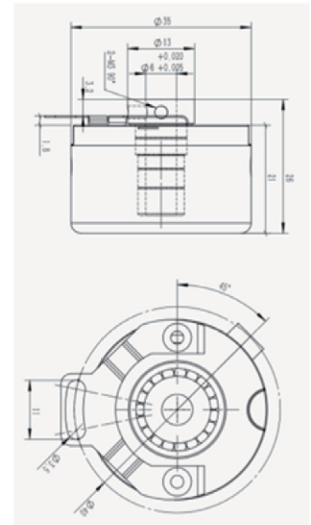
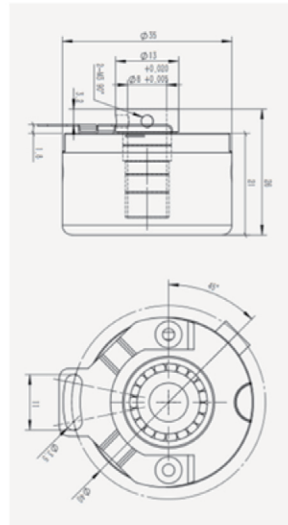

□ 3508-40 leaf spring

□ 3506-40 leaf spring

## General parameters

Installation type	Leaf spring+ shaft hole
Main size	Φ44mm
Flange material	cast aluminium
Output cable	Cable side output
Shaft material	Brass
Housing material	Plastic
Axial deviation	±0.1mm
Radial deviation	±0.1mm
Machine rotary speed	≤ 7200rpm
Anti-vibration	10g,10 ~ 2KHz
Impact resistance	100g,3ms
Weight	200g

## Environment parameters

Work temperature	-20°C~ +85°C
Stock temperature	-20°C~ +90°C
Protection level	IP40
Max humidity	85% No condensation

# SERVO ENCODER—ABSOLUTE

## Electrical parameters

### Optional parameters

Single turn resolution	17 位 □ / 23 位 □ / 25 位 □ / other
Cable	0.17m □ / 0.65m □ / other
Baud rate	2.5M □ / 5M □

### General parameters

Voltage	5VDC ±5%
Current Consumption	≤ 80mA
Multi-turn resolution	16bit
Operating principle	optical-electricity encoder
Multi-turn type	Battery multi turn
Battery voltage	3.6VDC
Battery current(motor stop)	8uA
Interface	RS485
Electrostatic discharge	Electromagnetic compatibility, compliant with IEC61800-3 standards
Power reverse connection protection	Yes
Overcurrent protection	Yes

### Wiring definition (RS485)

Signal	DC5V±5%	GND(0V)	Battery+	Battery-	RS485A+	RS485B-	Shield
Color	Red	Black	Brown	Brown/black	Blue	Blue/black	Thick black



## Servo encoder—— split magnetic encoder

- NO FRICTION BETWEEN ENCODER AND MOTOR
- CAN WITHSTAND LARGE INSTALLATION ERRORS IN THE AXIAL DIRECTION
- CAN WITHSTAND HARSH USAGE ENVIRONMENTS

## Machine parameters

### Optional parameters

Main size	Φ40mm × 13.8mm (Main body installation indexing circle × thickness)
Accessory magnetic steel	Φ10mm □ / Φ12mm □ / other
Accessory axle sleeve	Φ6mm □ / Φ8mm □ / other

### Machine size

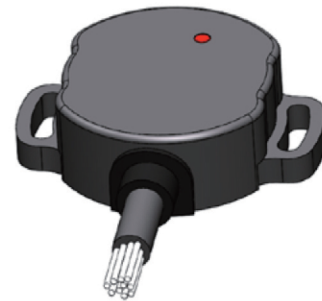
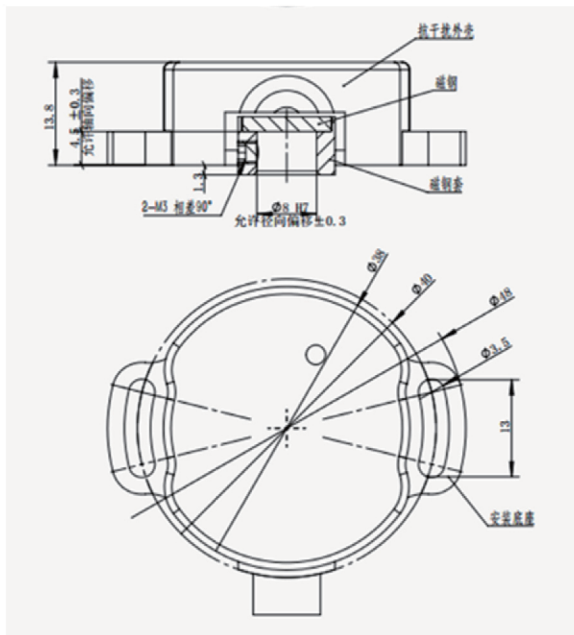

# SERVO ENCODER—— SPLIT MAGNETIC ENCODER

## General parameters

Installation wire hole indexing circle diameter	Φ40mm
Cable output type	Cable side output
Base material	plastic
Housing material	Ductile iron
Anti-vibration	10g,10 ~ 2KHz
Impact resistance	30g, every direction
weight	200g
Machine rotary speed	≤ 20000rpm

## Environment parameters

Work temperature	-20℃~ +85℃
Stock temperature	-20℃~ +90℃
Protection level	IP40
Max humidity	85% No condensation

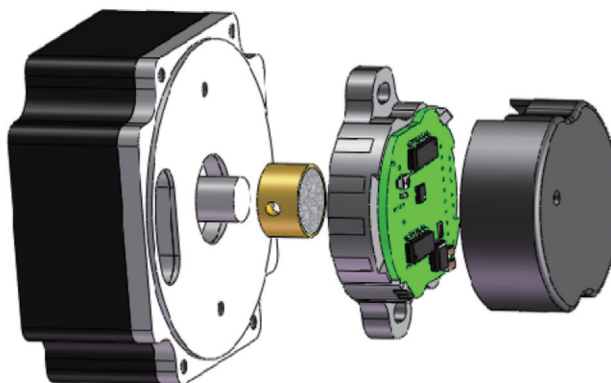



## Electrical parameters

### Optional parameters

Resolution	1000 □ / 1024 □ / 2000 □ / 2500 □ / 4096 □ / 5000 □ / other
Quantity of pole pair	4 □ / 5 □ / other
Cable	customized

### General parameters

Voltage	5VDC±5%
Current Consumption	≤ 20mA
Operating principle	Magnetic-electricity
Output form	Differential output
Electrostatic discharge	Electromagnetic compatibility, compliant with IEC61800-3 standards
Power reverse connection protection	yes
Overcurrent protection	yes

### Wiring definition (Standard type)

Signal	DC5V	GND(0V)	A	A-	B	B-	Z	Z-	U	U-	V	V-	W	W-	Shield
Color	Red	Black	Blue	Blue/black	Green	Green/black	Yellow	Yellow/black	Brown	Brown/black	Gray	Gray/black	White	White/black	Thick black

### Wiring definition (Save cable type)

Signal	DC5V	GND(0V)	A	A-	B	B-	Z	Z-	Shield
Color	Red	Black	Blue	Blue/black	Green	Green/black	Yellow	Yellow/black	Thick black

# SERVO ENCODER SPLIT MAGNETIC ENCODER (ABSOLUTE)



## Electrical parameters

### Optional parameters

Single turn resolution	17 位 □ / other
Baud rate	2.5M □ / 5M □
Cable	Customized

### General parameters

Voltage	5VDC ±5%
Current Consumption	≤ 80mA
Multi-turn resolution	16bit
Operating principle	Magnetic-electricity encoder
Multi-turn type	Battery multi turn
Battery voltage	3.6VDC
Battery current(motor stop)	8uA
Interface	RS485
Electrostatic discharge	Electromagnetic compatibility, compliant with IEC61800-3 standards
Power reverse connection protection	Yes
Overcurrent protection	Yes

### Wiring definition (RS485)

Signal	DC5V±5%	GND(0V)	Battery+	Battery-	RS485A+	RS485B-	Shield
Color	Red	Black	Brown	Brown/black	Blue	Blue/black	Thick black



Make the best encoder in China



[www.adk-auto.com](http://www.adk-auto.com)

**Company:** Weihai Idencoder Electronic Technology Co.,Ltd.

**A d d :** Building No.1, North District, Zhongke Innovation Industrial Park, Economic Zone,  
Weihai City,Shandong province, China.

**T e l :** 0086-631-5965950

**F a x :** 0086-631-5995628

**M . P :** 0086-15688681788 / 15662331682 / 13863032425

**E-mail:** sales07@idencoder.cn / sales04@idencoder.cn

**Website:** [www.idencoders.com](http://www.idencoders.com) / [www.adk-auto.com](http://www.adk-auto.com)

WEIHAI IDENCODER ELECTRONIC TECHNOLOGY CO.,LTD